

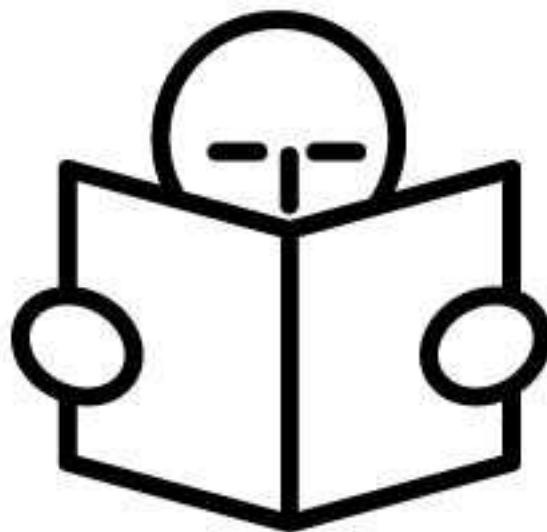

Please read the following before unpacking and installation, in order to avoid damages and incorrect installation. Otherwise, it is at your own risk and the guarantee becomes void.



All parts and packaging are photographed at the factory.



Watch our installation video.



Scan the QR code or visit www.lacuna.dk.



If possible, begin with the unpacking, assembling and installation of the frame.



If possible, leave the door-leaves on the pallet, until they can be installed in the (almost) finished frame.

Required tools/ people and materials for installation



2 people to install



Measure tape



If available, a suction cup for glass



Drill



Spirit level



Drill bit, 6.5mm



Power screwdriver



19 mm wrench



Blocks for installation of the frame

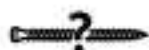

Screws in various lengths and qualities
(As Lacuna do not know if the folding door is being
installed in a timber, concrete or steel construction,
no fixing / frame screws are included.)

Order of installation



Assembling of frame 7



Installation of frame 8-9



Installation of door-leaves 10-16



Final installation of frame 17



Adjustment 18



Bill of materials 19

Descriptions

F

Component designation

3

Installation order 1- 22



Seen from the inside



Seen from the outside

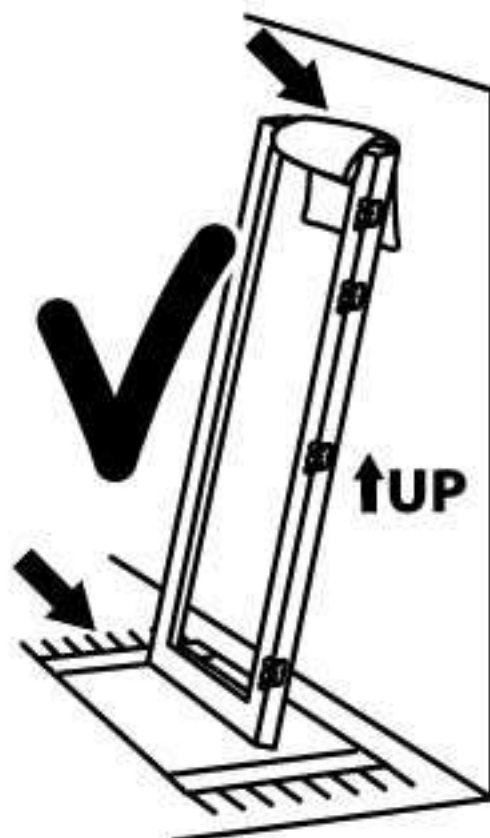
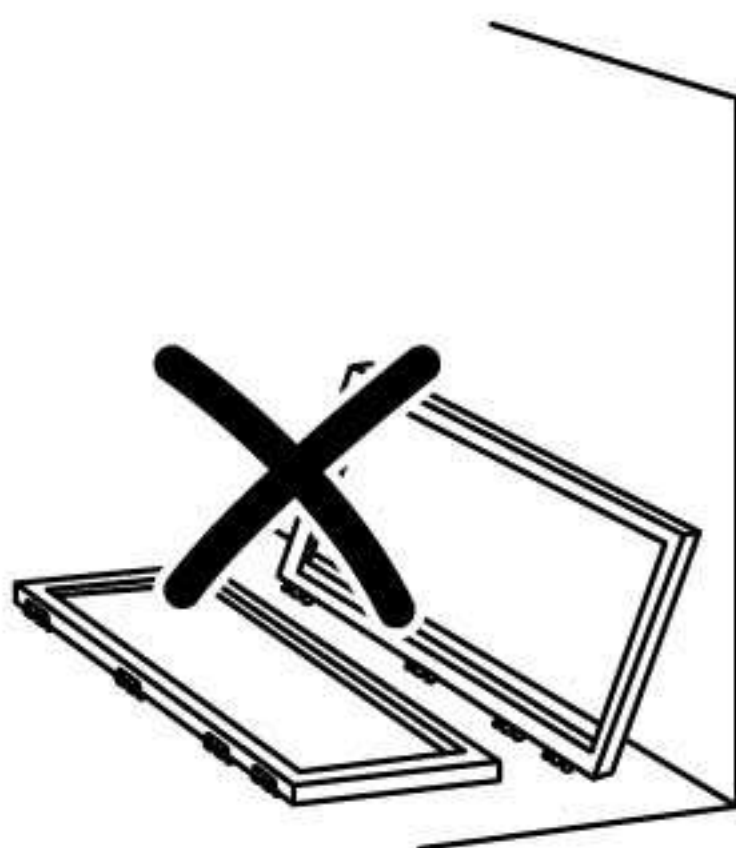

**Any questions regarding
the installation guide?**



**Please ring Lacuna:
Morten on 07507 644 621
or Vibeke on 07789 503 029**

Installation guide for semi/self-supporting folding doors and windows with integrated sliding rail

To facilitate adjustment, it is important that there is space for blocking up/alignment of the frame on all sides. A 12 mm clearance should therefore be allowed between frame and building. The 12 mm around the frame is a rule of thumb: The clearance could be uneven, so that 12 mm may be enough in some places, but not in others. It is important that the frame is installed exactly vertically and horizontally (remember cross measure).

PLEASE NOTE: The trolley should be put into the rail before the frame is set into the opening.

Please note that the load on each trolley is between 50 and 150 kg depending on door blade size. When the doors are folded, there can be a load of between 75 and 500 kg on just one meter of rail, where no deflection is allowed. For this reason, an exact, secure and stable installation of the rail and frame is crucial for a perfect result.

Folding doors from Lacuna can, if required, be readjusted with the enclosed 1 mm adjustment plates. Behind all hinges, a 1 mm adjustment plate can be added or removed if, at time installation or after later settlement, a small inaccuracy has occurred. For a perfect result it may well be that only certain hinges need to be adjusted by adding or removing the plates. It is not possible to adjust the hinges with a hinge bender. Adjustment of width should only be carried out with the enclosed 1 mm adjustment plates.



WARNING

If the top frame has been mounted incorrectly, the space between this and the top side of the door blades externally (reverse for internal opening doors) may be too small, and it may be impossible to adjust it sufficiently. At the same time, the space between frame and door internally will increase. If this happens, the door blades should be taken off, and the top frame/rail adjusted and remounted.

Kind regards
Lacuna A/S

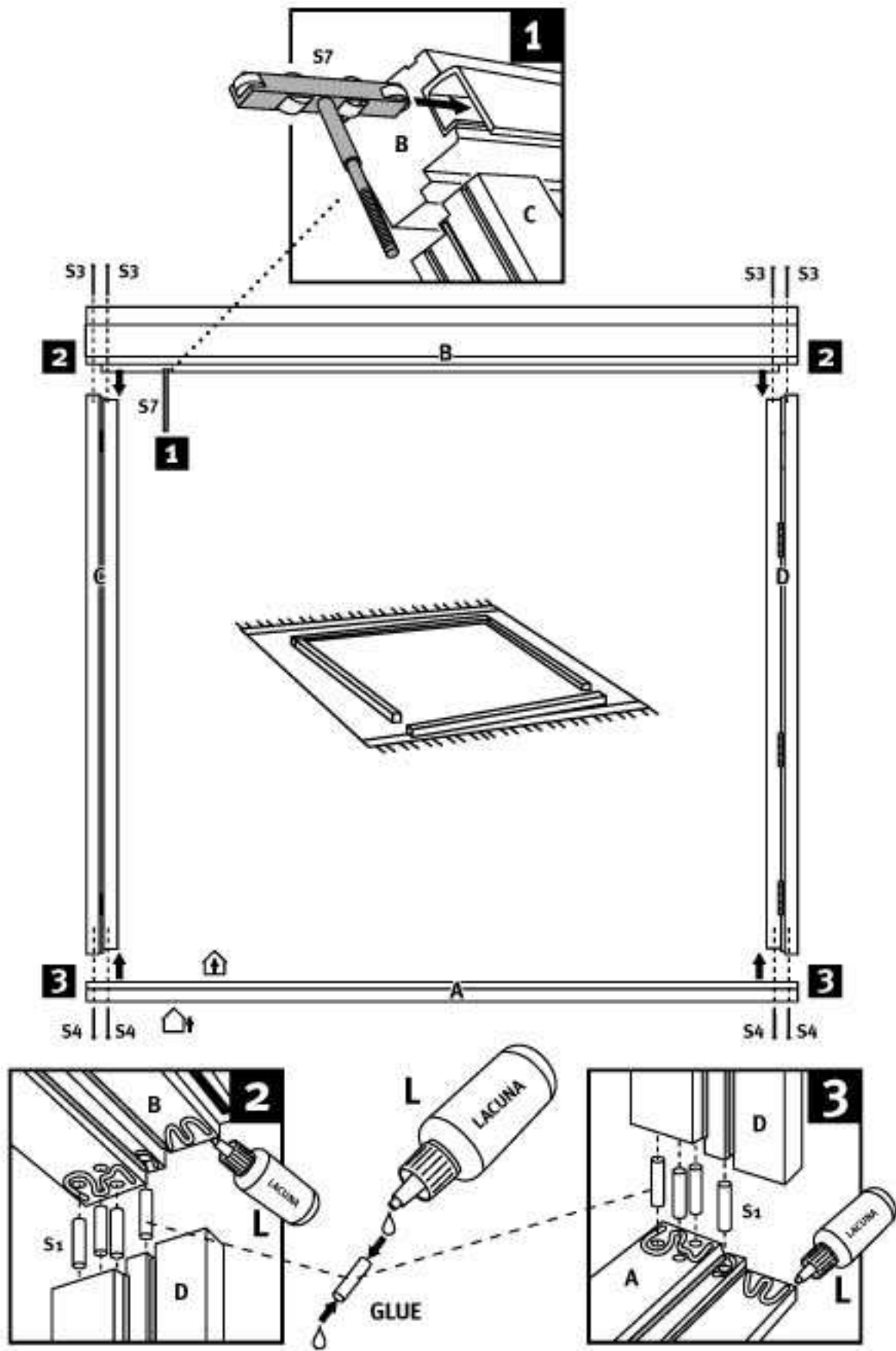

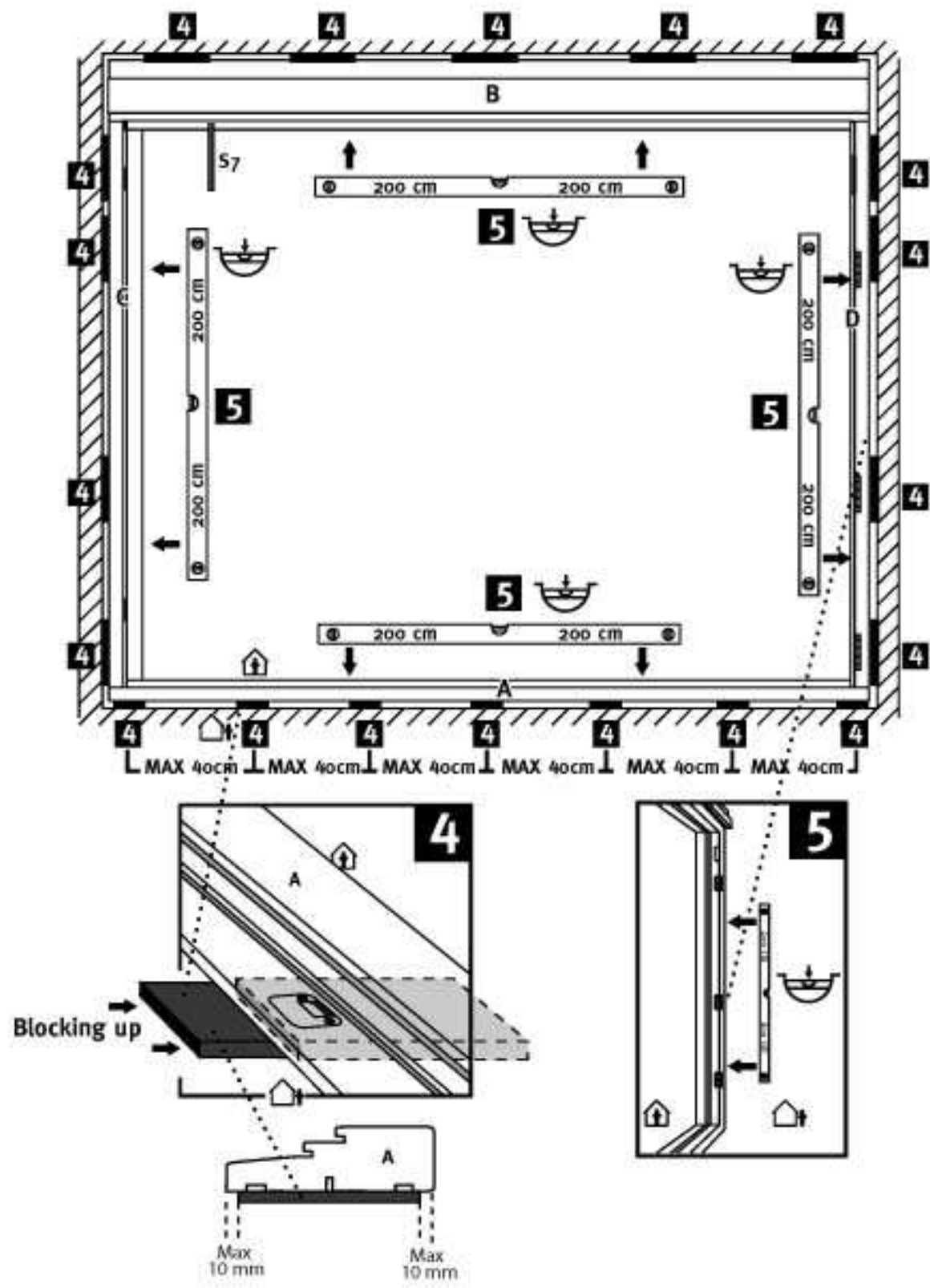

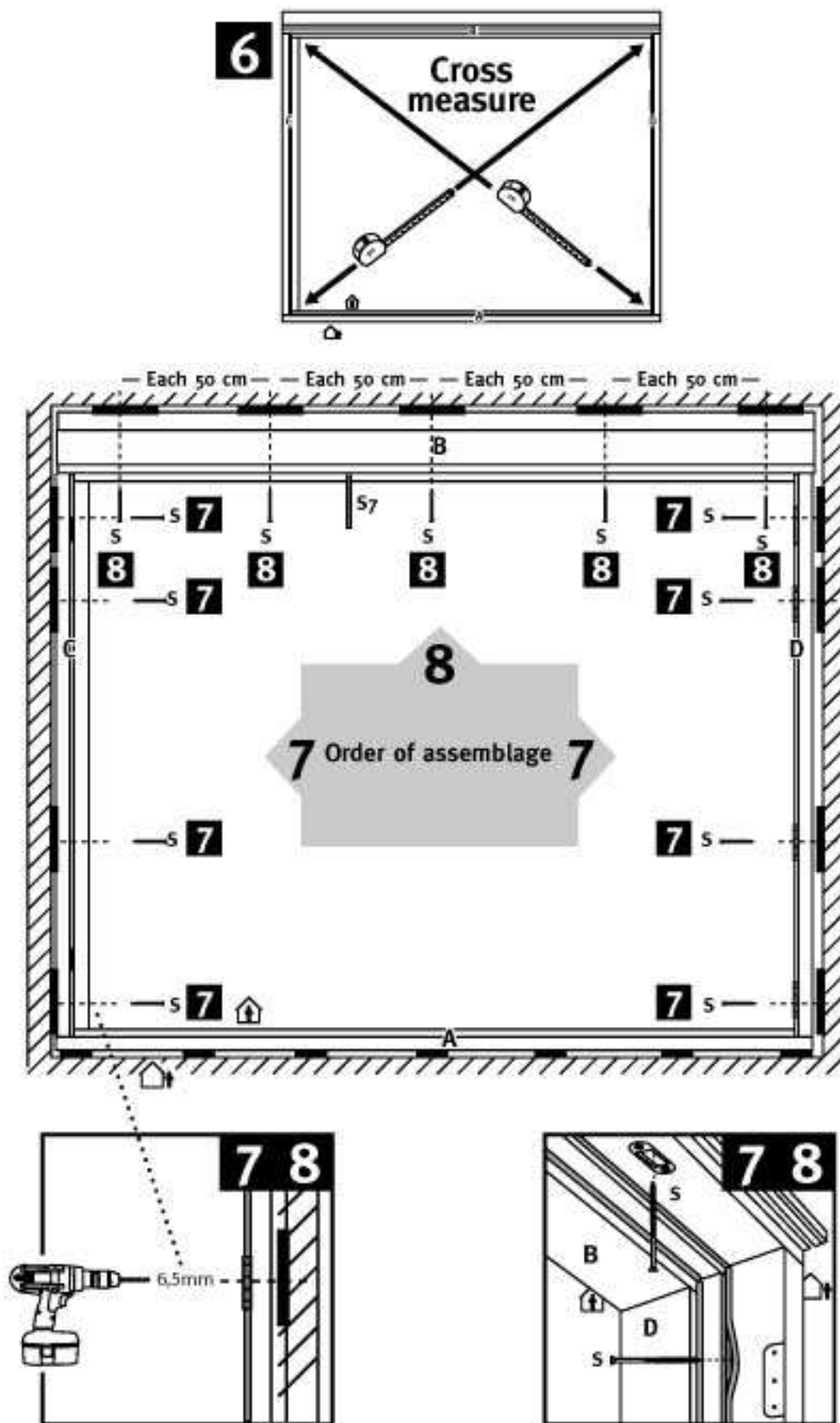

Hide screws if possible

(S) Screws for fixing frames are not included

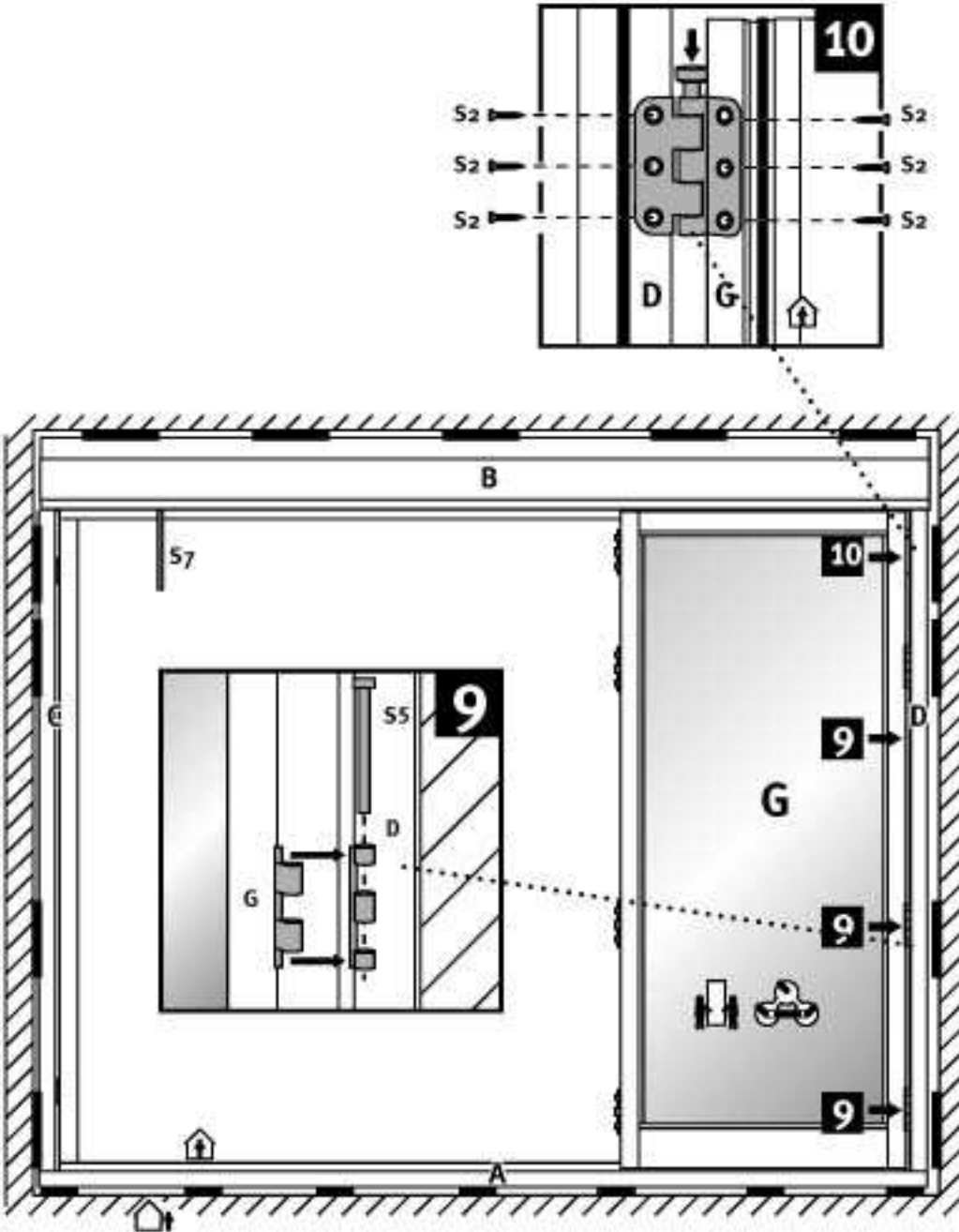

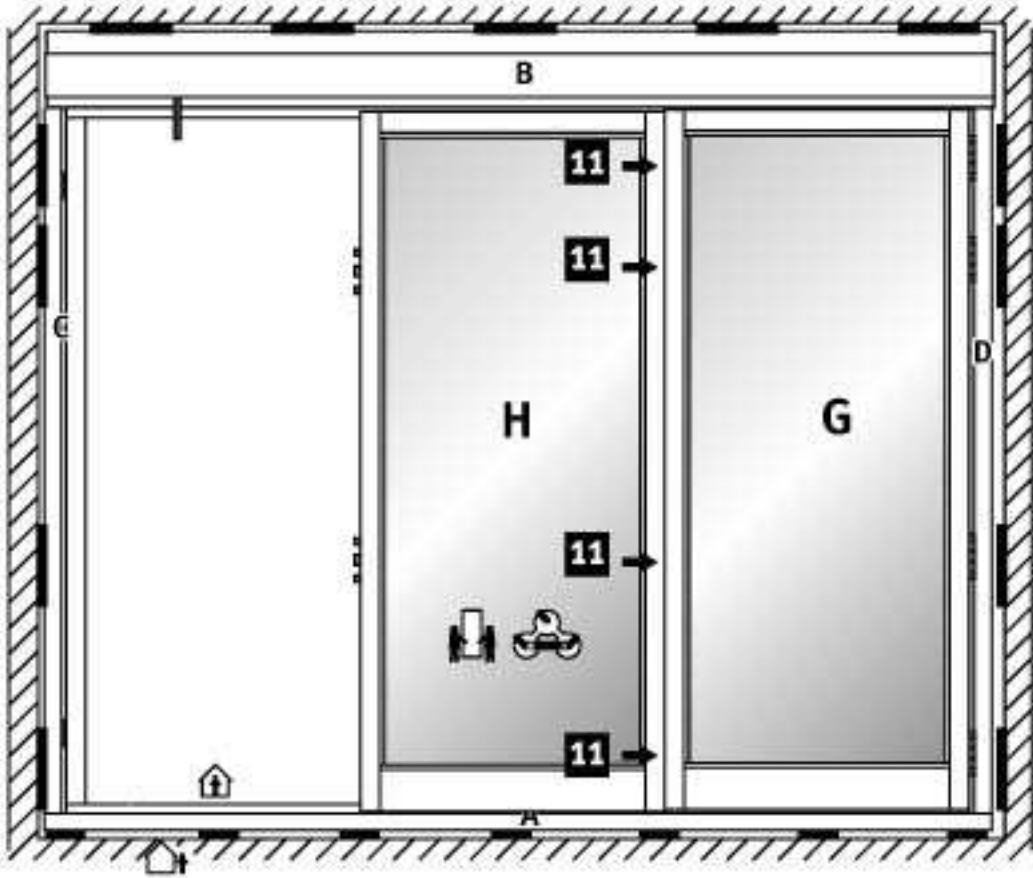

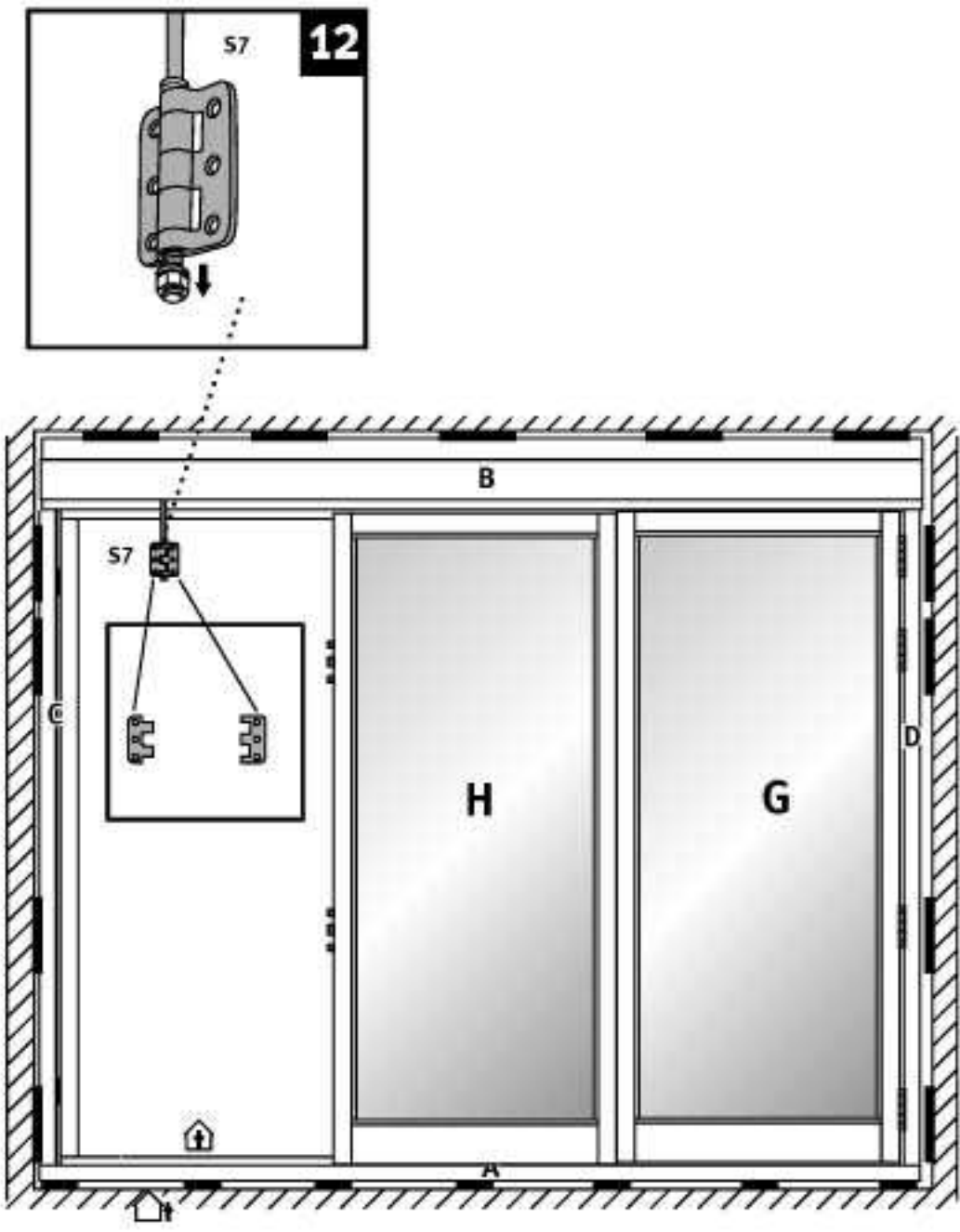

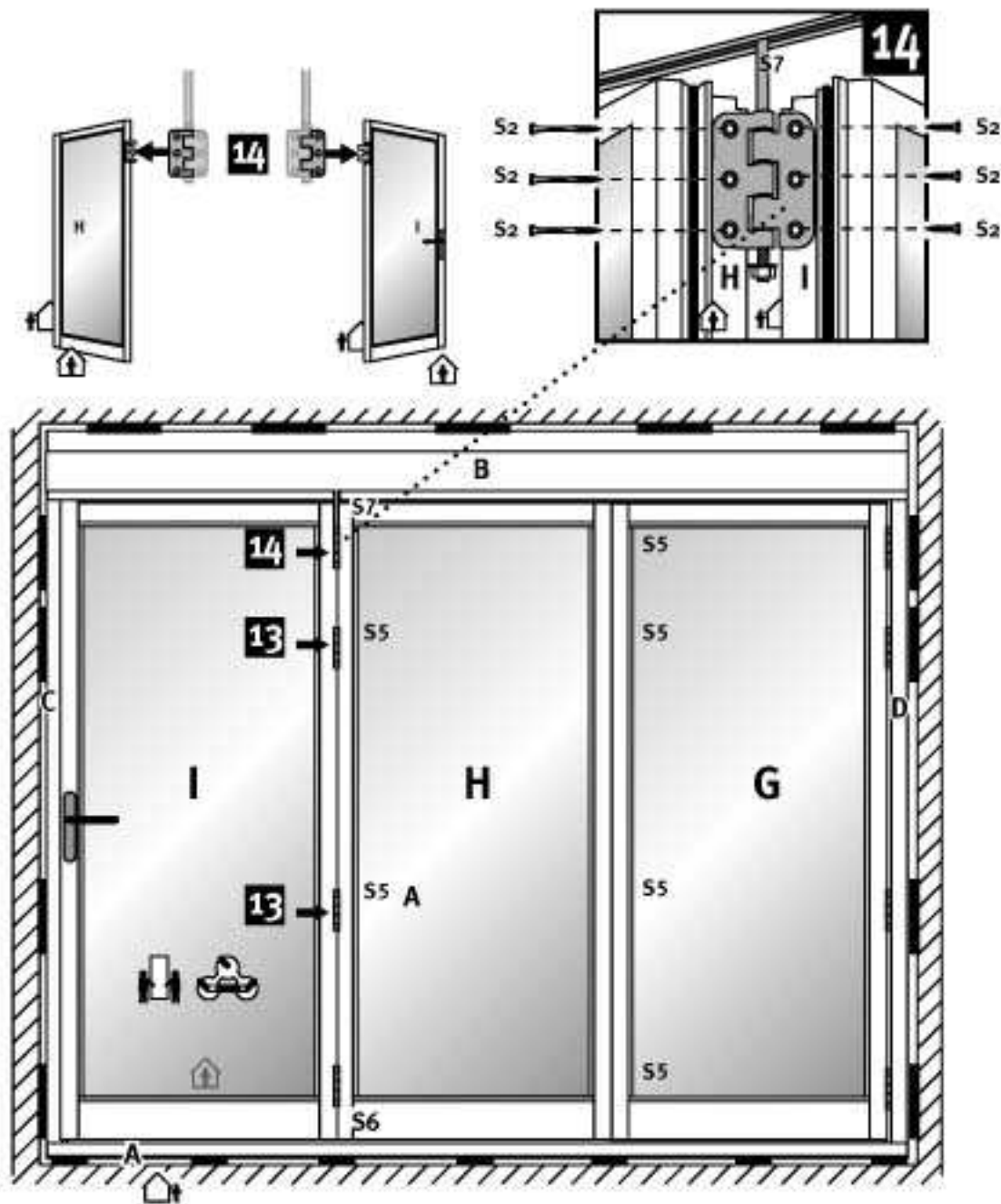

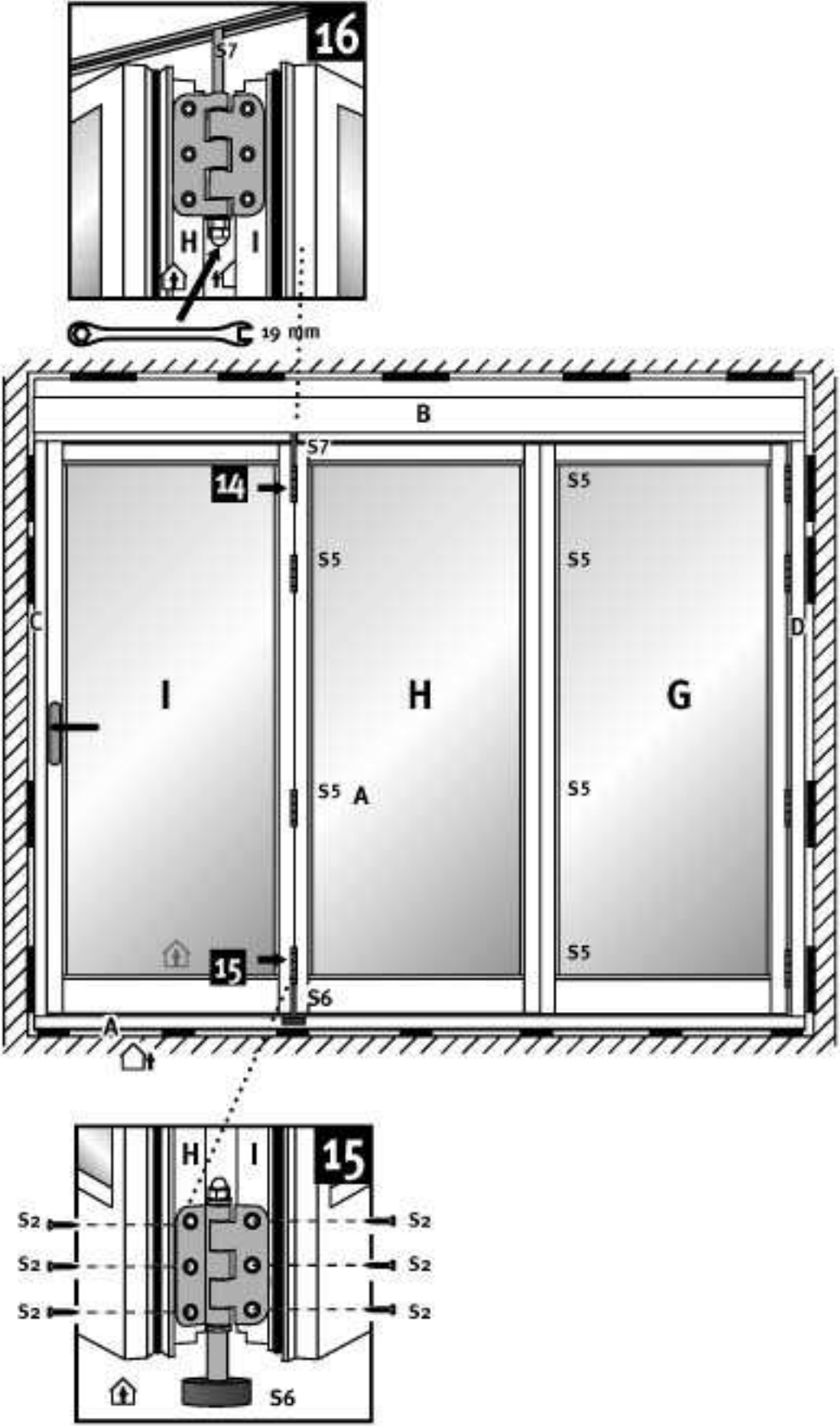

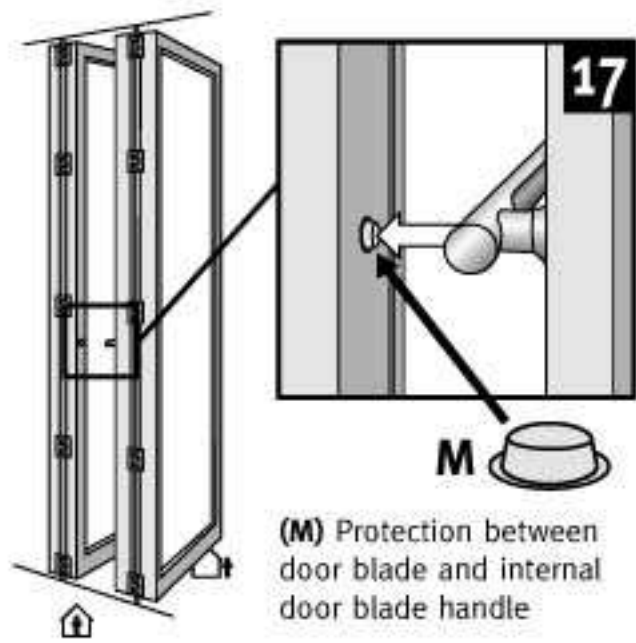

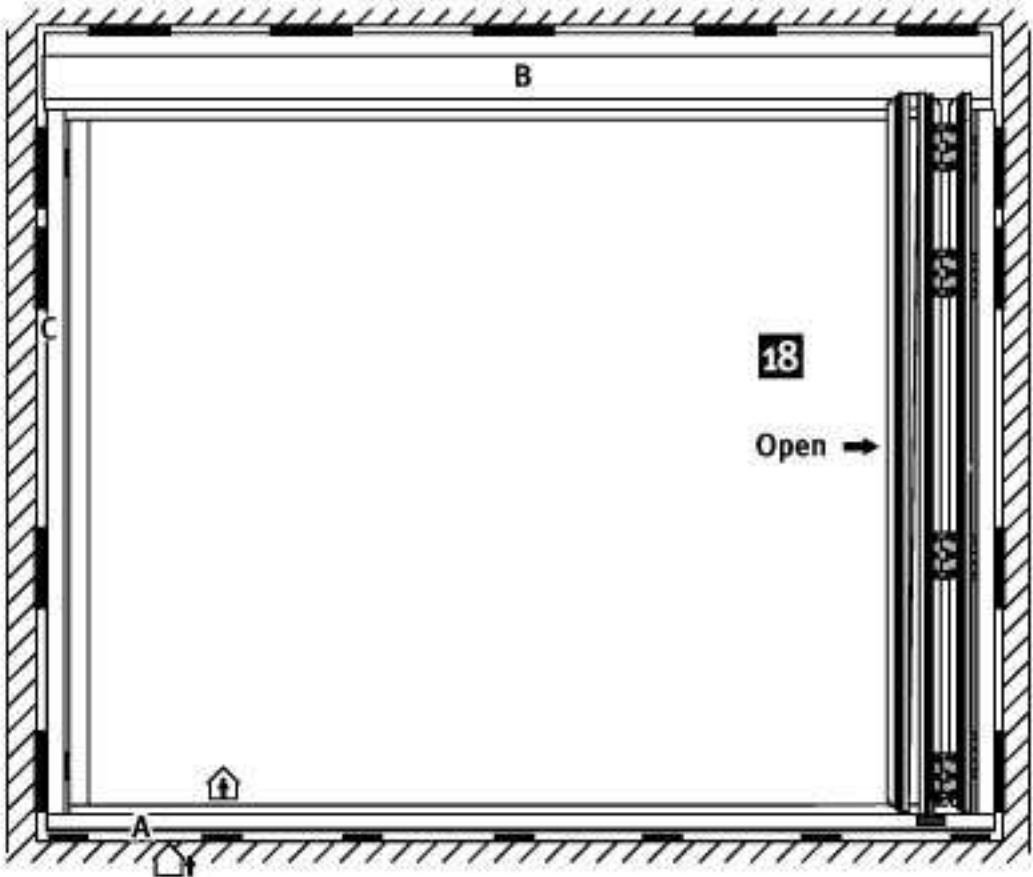

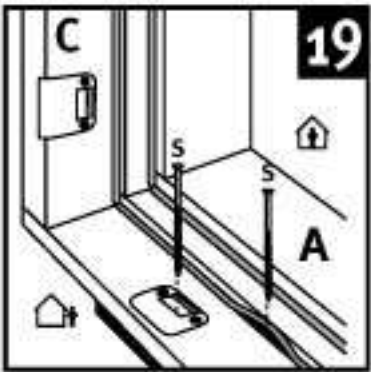
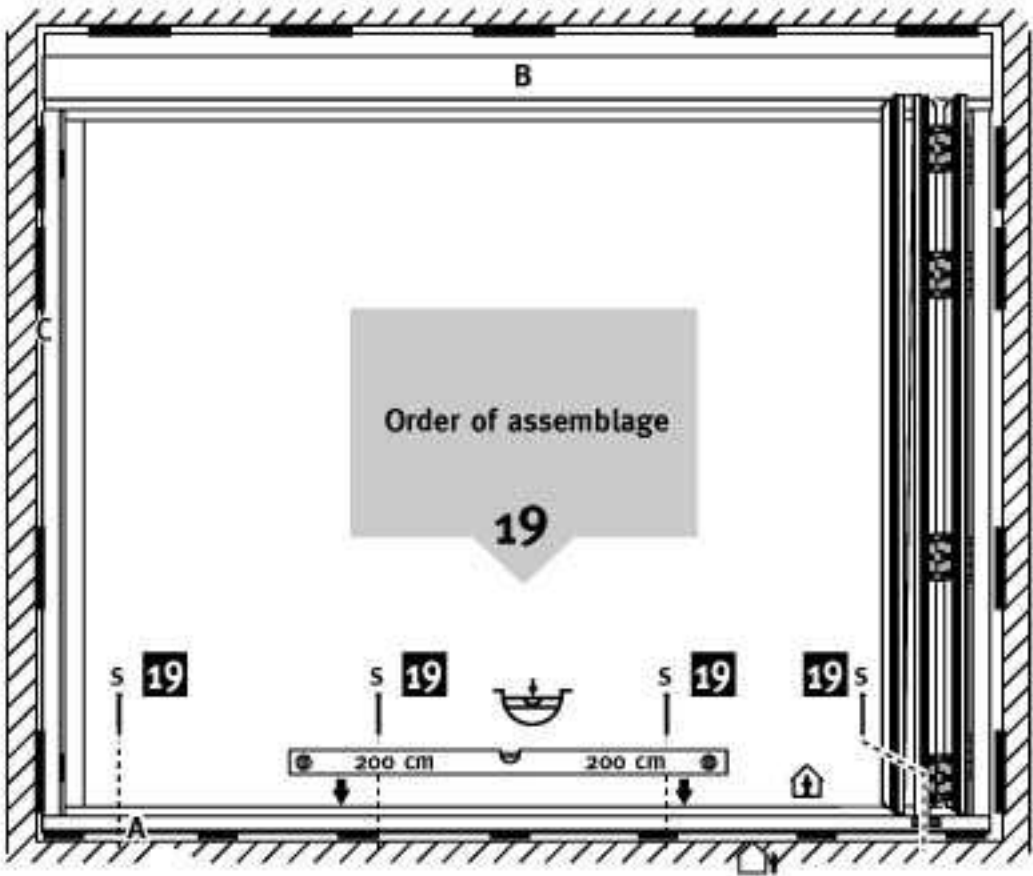

Hide screws if possible

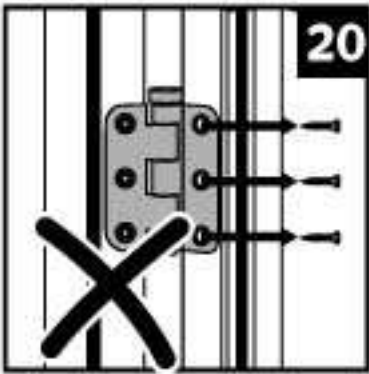
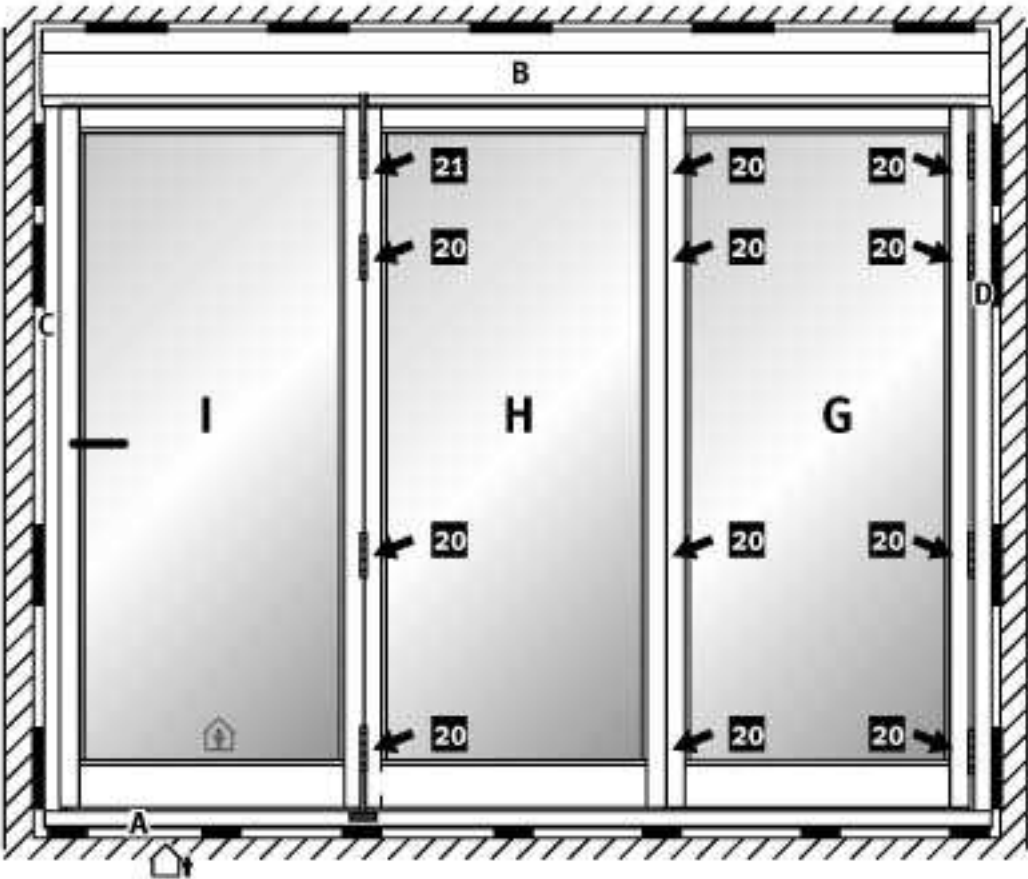

All screws in the hinge must be loosened before removal of the adjuster plates.

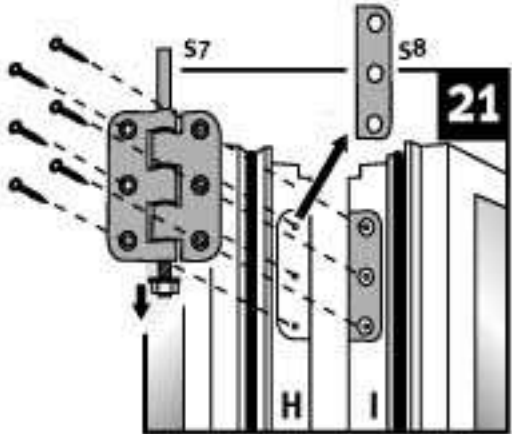
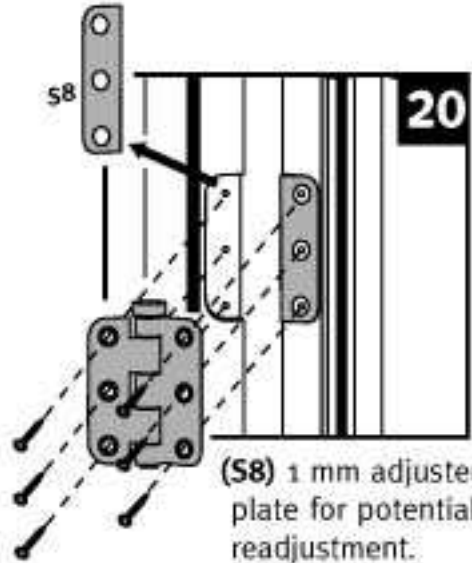
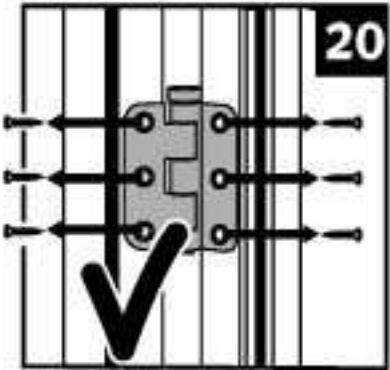

PCS/STK/STK

S1 5 x 90 mm

PCS/STK/STK

S2 5 x 30 mm

5 x 40 mm



PCS/STK/STK

S3 6 x 120 mm

6 x 150 mm



PCS/STK/STK

S4 5 x 90 mm

PCS/STK/STK

S5

PCS/STK/STK

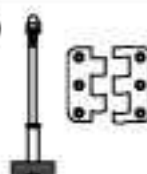
S6

PCS/STK/STK

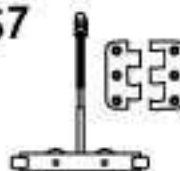
S7

PCS/STK/STK

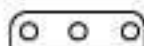
S8

PCS/STK/STK



PCS/STK/STK

ABand
Threshold

PCS/STK/STK

BTop
Top frame

PCS/STK/STK

C/DSide
Side frame

PCS/STK/STK

G/H

PCS/STK/STK

I

PCS/STK/STK

J

PCS/STK/STK

LTrælim D2 inde
Wood glue D2 indoor

PCS/STK/STK

Olie
Oil

PCS/STK/STK

Maling
Paint

PCS/STK/STK

M

PCS/STK/STK



PCS/STK/STK

PÅKØBT AF / PACKED BY:

(S) Screws for fixing frames are not included

(S) Schrauben und Befestigungsmittel zum Befestigen der oberen, unteren und seitlichen Hölzer sind im Preis nicht enthalten

(S) Skruer til montage af ramme medfølger ikke

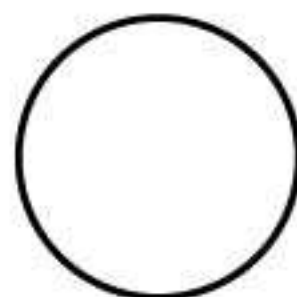

Guarantee

Guarantee and maintenance

Lacuna follows the guarantee from Vinduesindustrien - The Association of Danish Window Manufacturers. The guarantee requires that the following maintenance instructions are adhered to:

- Oiled surfaces must be maintained as required, and those facing the outside as a minimum re-oiled once a year.
- Painted surfaces must be washed and kept clean.
- Moving parts must be lubricated

Read more about maintenance on www.lacuna.dk › General information about Lacuna folding doors › Maintenance

Documentation

In order for the guarantee to take effect, this installation and Maintenance guide must be passed on to the end-user when installation is complete.