

Installation Guide Access Hatch DeckenTüre



Glue in sealing tape
(Installation Guide Connection System)

1 To make installation easier:
Detach hatch door with concealed hinges:

2 Place **frame** in ceiling opening and adjust:
- even out the surrounding gap (max. 2 cm)
- flush to ceiling (spirit level)
- at right angles (remeasure diagonals)
Underlay and screw tight (2x per side).

3 Screw **ring eye** flush into catch.

4 Click hatch door back into place:

5 **Align hatch door exactly:**
Adjustments with the appropriate screws:

depth ↑↓
width of gap left/right ↔
width of gap catch side / hinge side ↕



Push in insulation braid,
glue on sealing tape.
(Installation Guide Connection System)

6 **Adjust magnets** for proper closing.

After completion of any other work on the ceiling:

7 **Mount architraves:**
Interlock. Test. Uncover adhesive tape. Press on firmly. Fix.
(Installation Guide Architraves)

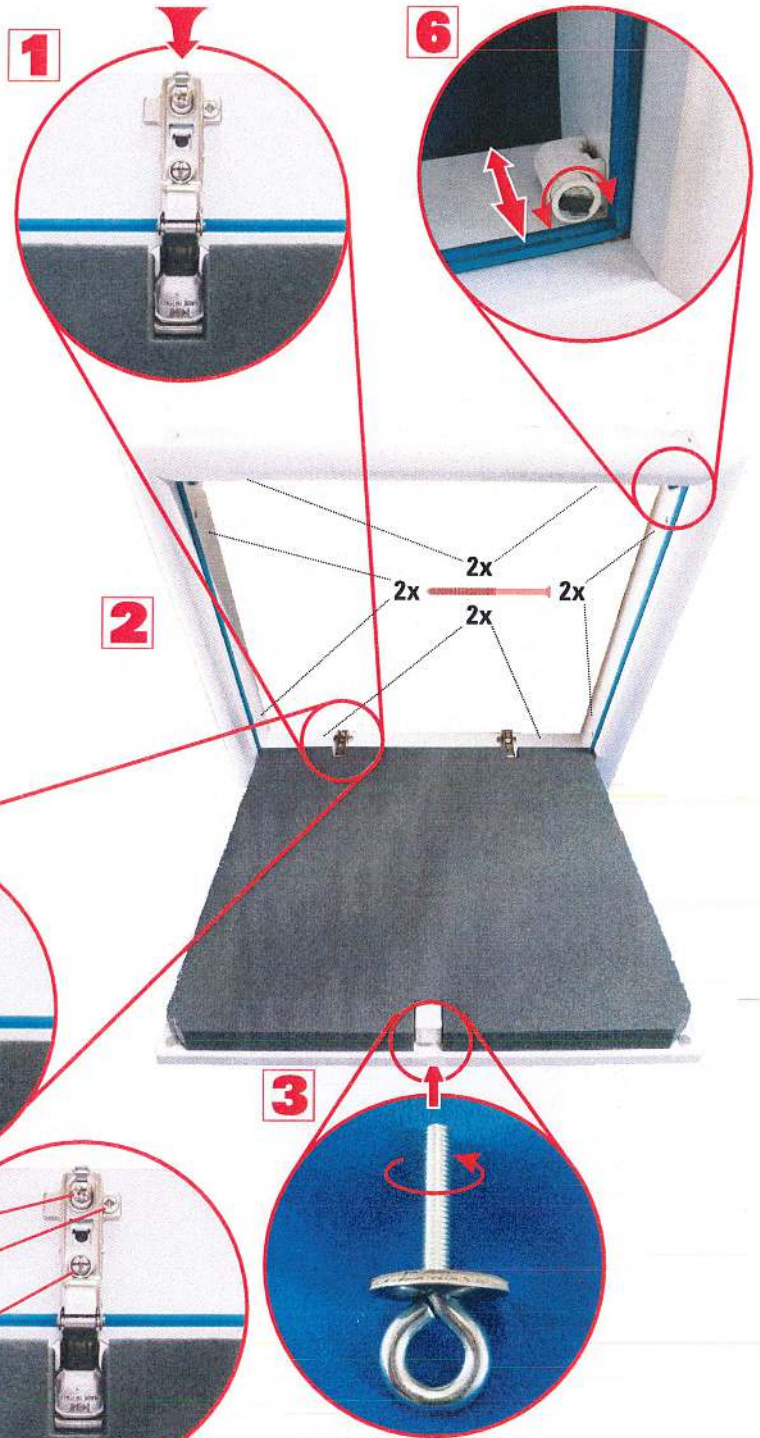

Safety instruction:
Do not lean ladder on access hatch door!

wellhöfer
TREPPEN AUS WÜRZBURG

Installation Guide Architraves

Unpack and mount architraves only after completion of any other work on the ceiling!

1

Interlock frame:

Interlock architraves to form a frame with the help of corner joints.

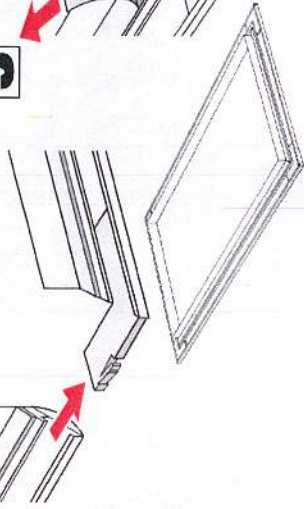

2

Attach frame by way of trial.

Uncover adhesive tape:

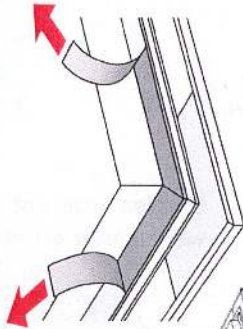

4

Mount architraves:

Keep attic hatch closed and press frame from below onto clean lining bar and press firmly.

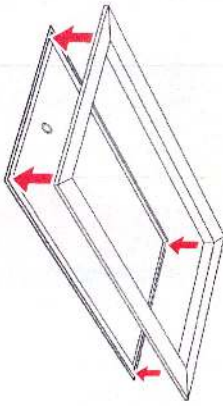

5

Secure architraves

with enclosed screws:

- use Bit-T10
- opening side 1x
- both longitudinal sides 2x
- distance to bottom edge 1.5 cm
- distance to corner 20 cm

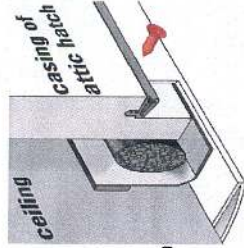

6

Remove protective foil from architrave bottom.

weilhöfer
TREPPEN AUS WÜRZBURG



244-915_E417

Installation Guide Architraves

Unpack and mount architraves only after completion of any other work on the ceiling!

1

Interlock frame:

Interlock architraves to form a frame with the help of corner joints.

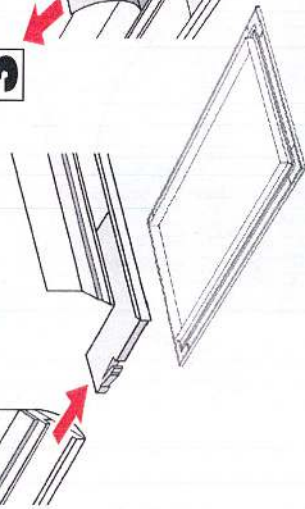

2

Attach frame by way of trial.

Uncover adhesive tape:

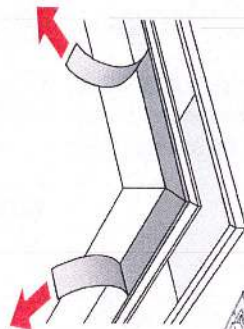

4

Mount architraves:

Keep attic hatch closed and press frame from below onto clean lining bar and press firmly.

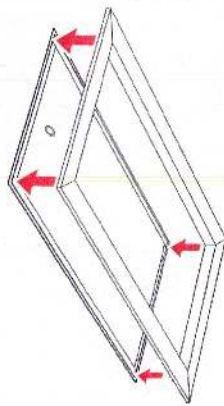

5

Secure architraves

with enclosed screws:

- use Bit-T10
- opening side 1x
- both longitudinal sides 2x
- distance to bottom edge 1.5 cm
- distance to corner 20 cm

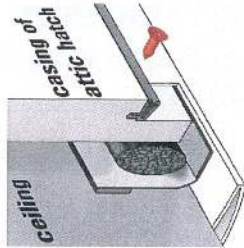

6

Remove protective foil from architrave bottom.

weilhöfer
TREPPEN AUS WÜRZBURG



244-915_E417

242-914_E417 Alle Angaben vorbehaltlich Übersetzungsmisverständnissen / All details subject to change due to translation difficulties.

Installation Guide Connection System

! Always apply sealing tape prior to installation of attic hatch!
! Watch ceiling construction! (see below)



1 Glue sealing tape in place:



Cut off in corners and re-apply.

3 Push in insulation braid:

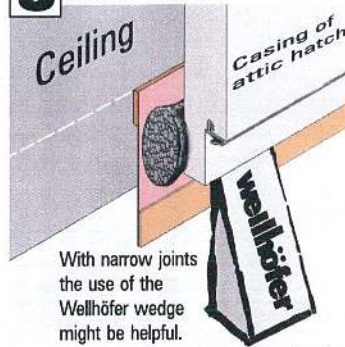

With narrow joints the use of the Wellhöfer wedge might be helpful.

Cut off in corners and re-apply. For close connection upset joints in the corners.

4 Closing the gap:

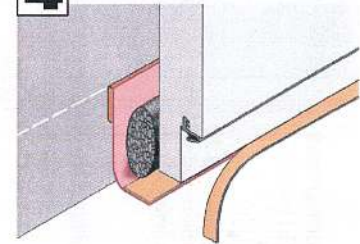

If required, cut projecting tape flush with joint angles.

Glue sealing tape to lining bar all over.

2 Install attic hatch
 (see Installation Guide Attic Hatch)



For attic stairs with fire protection:
 Push in hardly flammable fire protection braid instead of insulating braid!
 (see Installation Guide Attic Hatch)

5 Install architraves
 (see Installation Guide Architraves)

Full effect is gained only if the ceiling connection system has been implemented as described above.



Correct air-tight connection:

! Glue Wellhöfer sealing tape tightly and securely onto the on-site air-tight barrier!
 Watch ceiling construction / thermal bridges / fire protection regulations and where necessary fill additional insulation into gap on-site.



Concrete ceiling

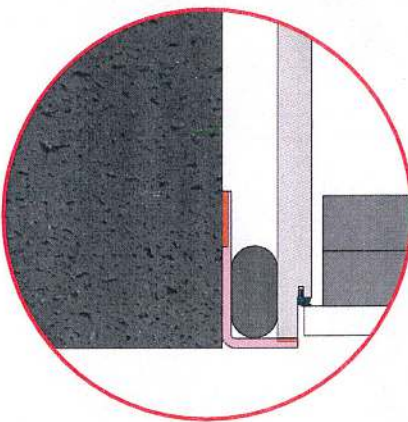

Suspended ceiling

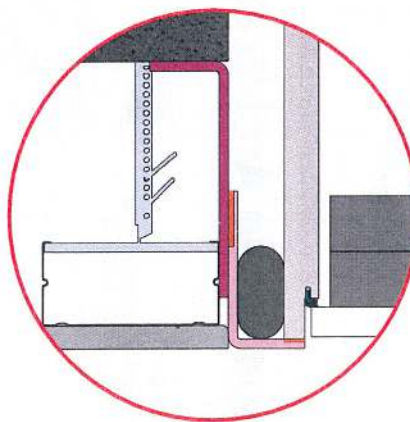

Wooden beam ceiling with counter battens

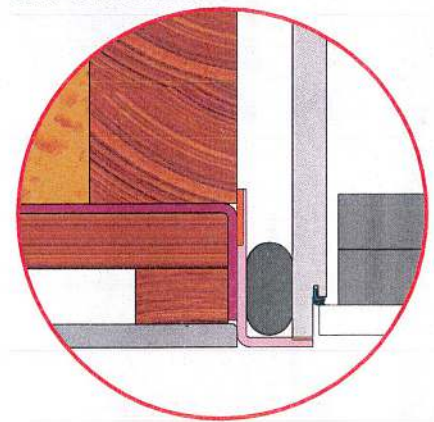

Wellhöfer thermal protection WS with connection system:
 Meet the requirements of the EnEV (German Energy Saving Act).



242-117_E417 Alle Angaben vorbehaltlich Übersetzungsmisverständnissen / All details subject to change due to translation difficulties.